

Installation

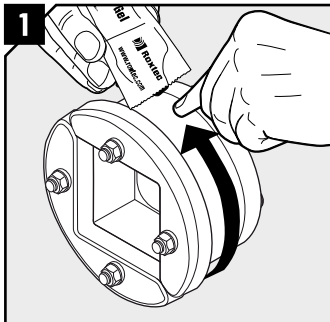

1 Lubricate the frame sparsely on the outside black rubber part with Roxtec Assembly Gel.

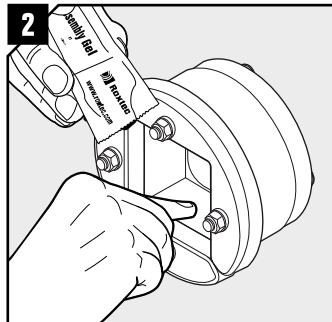

2 Lubricate the inside faces of the frame thoroughly, especially into the corners.

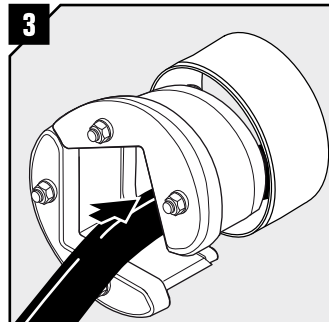

3 Insert the frame into the sleeve opening.

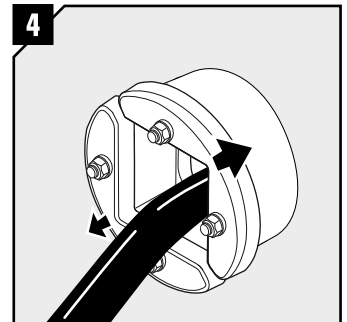

4 Loosen the nuts and push the front fittings to the sides.

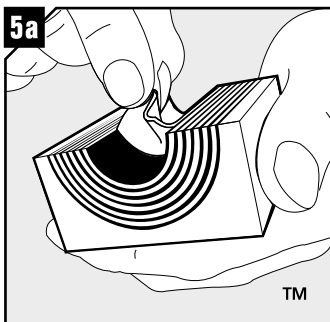

5a Adapt modules which are to hold cables or pipes by peeling off layers until you reach the gap seen in pic. 5b.

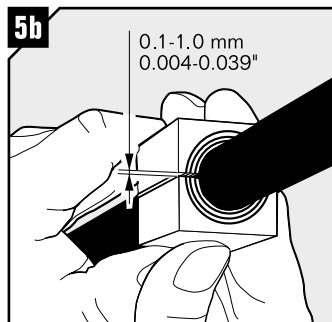

5b Achieve a 0.1-1.0 mm (0.004-0.039") gap between the two halves when held against the cable/pipe.

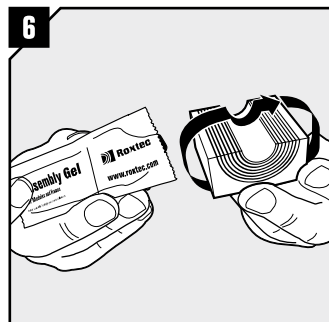

6 Lubricate all modules for the frame thoroughly, both the inside and the outside surfaces.

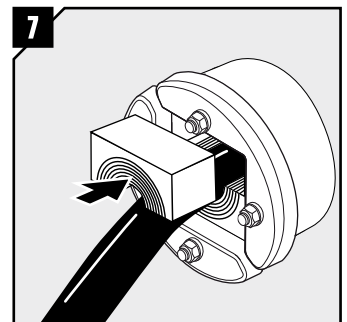

7 Insert the modules in the frame.

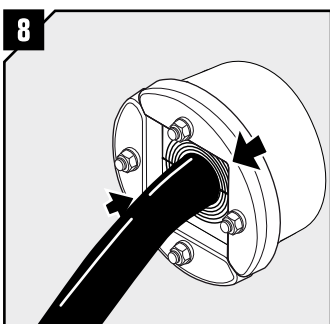

8 Push the front fittings back towards the centre.

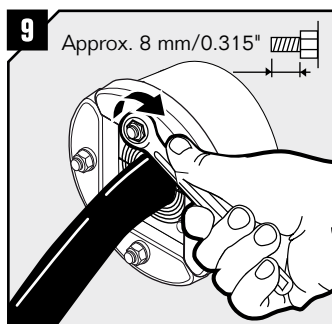

9 Tighten the nuts. Max torque is 4 Nm/2.95 lbf-ft.

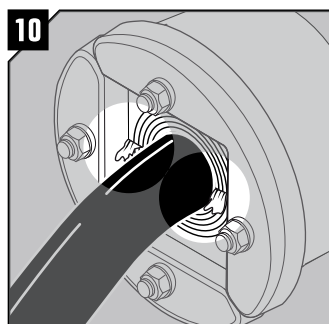

10 Excess Roxtec Lubricant will protrude when tightening the seal.

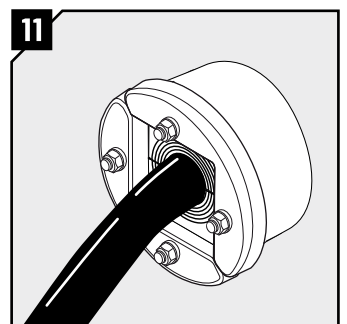

11 The installation is complete.

Disassembly

Reverse order

Note

- For optimum reliability, wait 24 hours or longer after installation before exposing the cables/pipes to strain or pressure.
- Cables/pipes shall be routed perpendicularly to the wall.

Roxtec CRL kits

For 1 cable

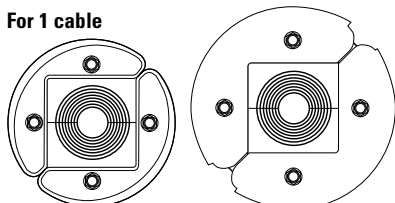

Roxtec CRL 4"/1

Roxtec CRL 5"/1

Pcs	Module	(mm)	For cable diameter (in)
1	CM 66	0+24-54	0+0.945-2.126

For 4 cables

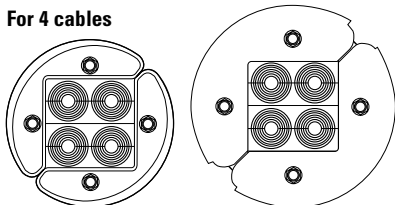

Roxtec CRL 4"/4

Roxtec CRL 5"/4

Pcs	Module	(mm)	For cable diameter (in)
2	CM 33w66	2x0+10-29	2x0+0.394-1.142

For 5 cables

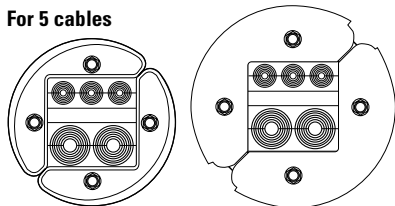

Roxtec CRL 4"/5

Roxtec CRL 5"/5

Pcs	Module	(mm)	For cable diameter (in)
1	CM 22w66	3x0+5-16.5	3x0+0.197-0.650
1	CM 11/0		
1	CM 33w66	2x0+10-29	2x0+0.394-1.142

For 9 cables

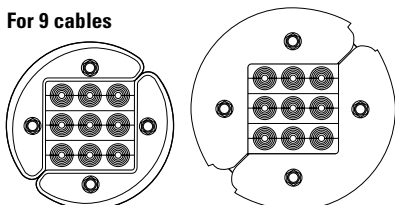

Roxtec CRL 4"/9

Roxtec CRL 5"/9

Pcs	Module	(mm)	For cable diameter (in)
3	CM 22w66	3x0+5-16.5	3x0+0.197-0.650

- All kits include Roxtec Assembly Gel and installation instructions.

